

OEM Lighting Controls

Products & Solutions





Maintaining your brand's bright reputation

As a leaders in energy-saving lighting controls since 1970, CP Electronics has many long-established partnerships with lighting manufacturers around the world. And to maintain the highest standards of service and client liaison, we created CP OEM - a specialist business unit. You can rely on CP OEM to live up to the promise of your brand.

Collaborative relationships

We work closely with lighting manufacturers, meeting their needs for design, technical collaboration and production standards. CP OEM takes your company's brand reputation as seriously as we do our own; our reputation for quality speaks for itself.

Design Innovation

CP Electronics invest heavily in the research and development (R&D) of new cutting-edge products and technologies. Our ethos has always been to innovate new ways for our customers to save money and minimise environmental impact without sacrificing functionality or aesthetic. These underpinning values are complemented by a constant drive towards simplicity. We create products with the user in mind.

Our R&D team include some of the brightest and most experienced R&D engineers in the industry. And our investment in R&D, is acknowledged as higher than the industry standard.

Our internal designers and/or technical services engineers work closely with you to ensure the product performs to your requirements. Our expertise extends from mechanical design of form factors, through to software for simple set-up and electronic design.



Contents

Manufacturing Excellence

4



Global Projects & Sector Coverage

6



Stand-alone Detectors

8



Infrared Handsets

17



Low Temperature Detectors

18



KNX Presence Detectors

18



System Integration

19



An-10 Wireless Lighting Control

20

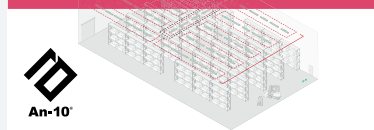

D-Mate Room Control System

22

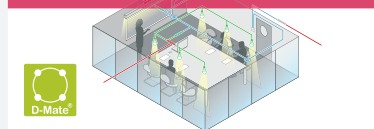

Working methodology

Each working partnership is unique – but here's a typical working process:

- Consultation: We begin the process by understanding your requirements. We'll appoint a dedicated CP OEM expert to give you a single point of contact.
- Scoping: We'll consider mounting heights, ambient temperatures, water ingress protection, timescales and budgets when scoping the project.
- Recommendation: After a thorough analysis of your requirements we'll make our recommendations, as well as providing lead times and projected costs.
- Testing: We test the solution to ensure it meets all your requirements and performs to CP Electronics performance standards.



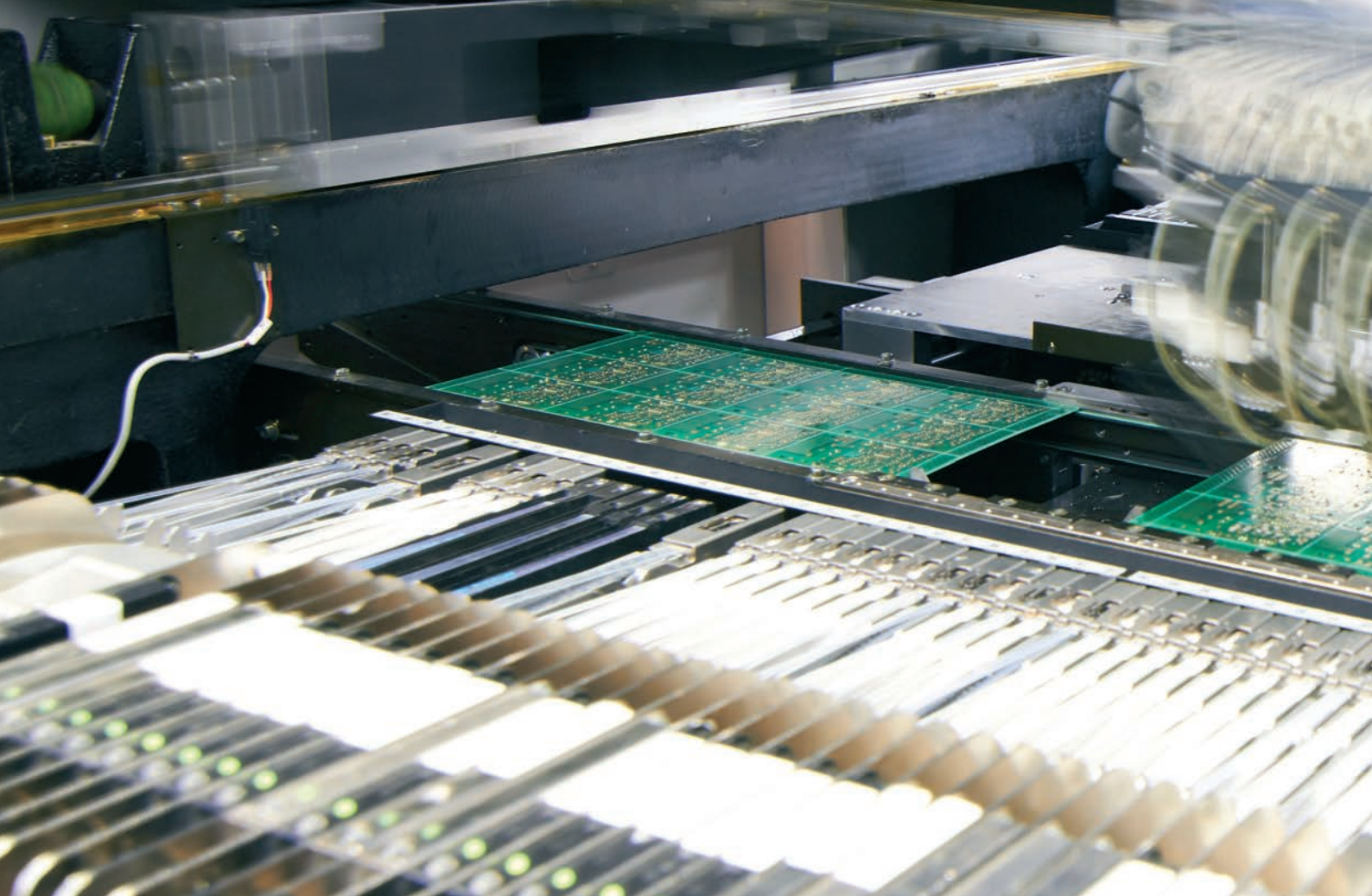

Manufacturing excellence

CP Electronics has grown to become the industry leading manufacturer of lighting controls for the UK. At the heart of the CP Electronics success story is an adherence to a specific set of values, one of which is quality.

Production facility

We employ approximately 200 people at our headquarters in Wembley, close to the heart of London in the UK. The majority of our products is manufactured here, using high quality materials, cutting edge production techniques and a highly skilled workforce. This operational strength ensures that we have total control of quality standards all the way from product development and testing to assembly, packaging and distribution.

Quality assured

We work to high quality standards, using advanced production techniques. All our components are thoroughly tested in-house to deliver consistent performance and endurance in their intended application.

We're so confident of our quality and testing regime that we offer a 5-year warranty on all our products.

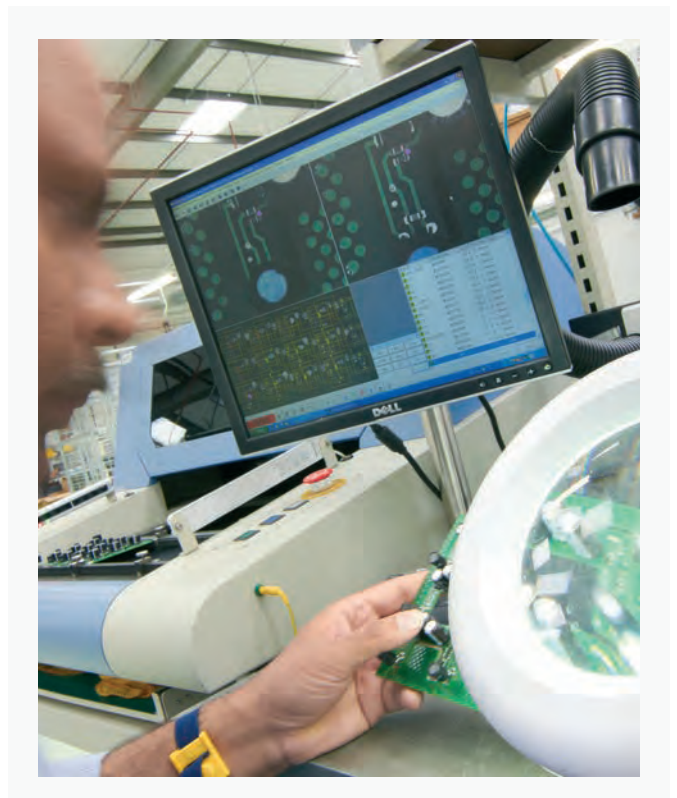



Accreditations

CP Electronics works to the highest standards of health & safety, with a safe, well-trained and competent workforce and the lowest possible risk of production delays, something which was independently verified in 2016 when it was awarded the prestigious BS OHSAS 18001-2007 international safety standard.

We believe CP Electronics is the first lighting controls supplier to have also received this award in conjunction with the ISO 9001-2008 for compliance to strict assembly and test procedures, and ISO 14001-2004 environmental standards.

Our products carry the CE mark. We are also active members of the Energy Systems Trade Association (ESTA).

Technical support

All CP Electronics products are backed by dedicated sales, after-sales and technical support teams. We work with OEM manufacturing partners around the world, whether on site, by telephone or online.

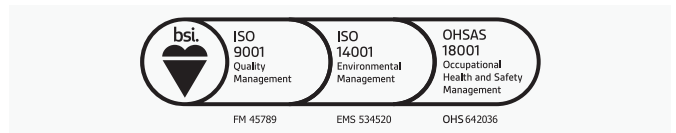



Blakemore foods



Winyu House



Reading station

Global Projects & Sector Coverage

Winyu House, Australia

Brief:

A new, four-storey ACT Government office block in Canberra, designed with a large public accessible ground floor and three levels of office space connected by a central atrium.

With a minimum 4.5 star NABERS rating specified, the energy efficient lighting needed to incorporate zone controls, using natural light where possible from the central atrium.

Solution:

400 **KNX-compatible** compact ceiling mounted PIR presence detectors - with two switch inputs, programmable logic block and full scene selection. Also includes absence detection, and user-configurable logic functions and timers.

Blakemore Foods, UK

Brief:

Blakemore foods, an established multi-temperature food distribution company, required an energy efficient scheme for illumination of their warehouses. Various mock ups were carried out to find the best design approach.

Solution:

Integration of the **EBDHS-MB-LT30** batten mount, low temperature high bay PIR detector. These are programmed to harvest daylight, and interact with the different levels of operation occurring in warehouses with low ambient temperatures. This is predicted to contribute to the overall target ROI of 1.3 years within the complete lighting design.

Reading Station Car Park, UK

Brief:

To improve the existing lighting scheme and provide effective control for 10 levels and 1600 car parking spaces, in use 24 hours a day. This required combining energy control products with new installation of LED luminaires to maximise cost savings and ROI.

Importantly, the scheme had to provide security, safety and overall comfort on entry/exit of the car park.

Solution:

One **EBMPIR-MB** batten mount PIR detector- controlling every third LED luminaire

Luminaires dimmed to 10% when not in use, to fulfil safety requirements, brightening when sensing vehicle or user movement.



Cheesegrater



Bluebell park apartments



Farmers distribution centre



Cheesegrater, UK

Brief:

122 Leadenhall Street, London, the iconic "Cheesegrater" awarded BREEAM rating "excellent" required flexible lighting control for the building owners and the occupants of multiple spaces.

Solution:

An-10 wireless lighting control systems for individual rooms while reducing physical communications cable.

Occupancy control with absence detection provides increased flexibility with users, while **DALI** dimming is a robust platform for control and addressability within the building's spaces. Daylight linking balances with available natural light to increase overall building efficiency.

Bluebell Park, UK

Brief:

Bluebell Park Apartments, built in Huyton, offers apartments specially designed to cater for the health and care needs for those over the age of 50.

50% of lights needed to be controlled by presence detectors to help to minimise any unnecessary energy consumption and cost incurred. The lighting control system also needed to link with the building's fire alarm system.

Solution:

CP's patented **An-10** wireless lighting control system integrated conveniently with the complex's internal clock and fire systems.

Farmers Distribution Centre, New Zealand

Brief:

A new 4-level distribution centre and warehousing facility for the iconic brand. Field trials were carried out to prove the unparalleled range of the **EBDHS-DD** detectors, and their ability to meet the required detection criteria even when mounted at heights of 20 metres.

Solution:

Application of 80 High Bay EBDHS dimming detectors, providing presence detection and daylight harvesting, integrated with a comprehensive lighting control system which links the old and new distribution centres.

EBMPIR | Miniature Detectors



The EBMPIR series of miniature passive infrared (PIR) presence detectors are ideally suited for applications that require an unobtrusive solution or where space is at a premium.

- Small and unobtrusive design
- Supplied pre-wired with an RJ11 plug for connection to the relevant power supply
- Infrared programmable
- For mounting at heights up to 2.8m
- A selection of fixing clips to allow the unit to be mounted in or to the side of a luminaire are available
- Please see page 16 for power supply options and information

Dimensions (mm)

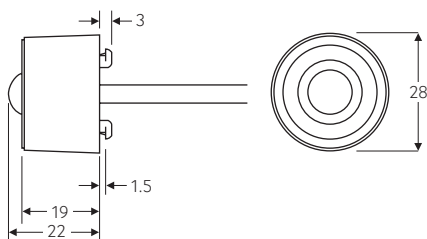

Detection pattern

high < sensitivity > low

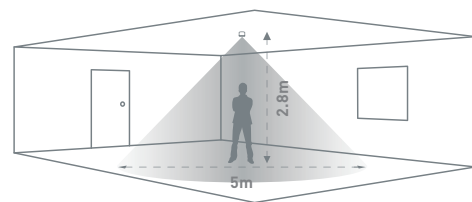

Available versions

- PRM – Switching
- DD – DALI/DSI dimming
- AD – Analogue dimming
- LV – Low voltage

EBMHS | Miniature Detectors



The EBMHS series of miniature PIR presence detectors provide automatic control of lighting loads with optional manual control.

- Small and unobtrusive design
- Supplied pre-wired with an RJ11 plug for connection to the relevant power supply
- Infrared programmable
- For mounting at heights up to 7m
- A selection of fixing clips to allow the unit to be mounted in or to the side of a luminaire are available
- Please see page 16 for power supply options and information

Dimensions (mm)

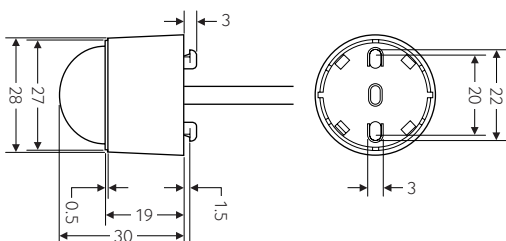

Detection pattern

high < sensitivity > low

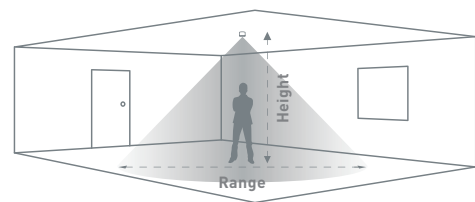

Height	Range
2.8m	9 x 9m
7m	16 x 16m

Available versions

- PRM – Switching
- DD – DALI/DSI dimming
- AD – Analogue dimming
- LV – Low voltage
- OC – Open collector

EBMPIR-MB | Batten Mounted Detectors



The EBMPIR-MB series of batten mount PIR presence detectors have been designed specifically for mounting on to a batten style luminaire.

- Batten mount retrofit solution
- Integrated power supply
- Suitable for a wide range of luminaires
- Supplied with comprehensive fitting kit
- Supplied with 1m lead
- For mounting at heights up to 7m

Dimensions (mm)

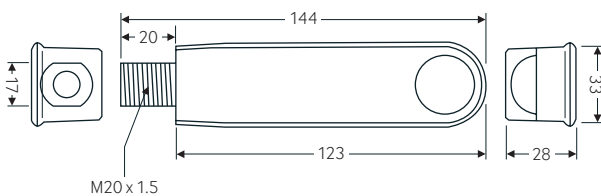

Detection pattern

high < sensitivity > low

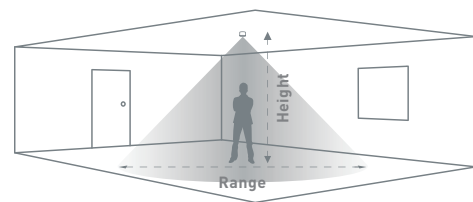

Height	Range
2.8m	7 x 7m
5m	10 x 10m
7m	16 x 16m

Available versions

- PRM – Switching
- DD – DALI/DSI dimming
- AD – Analogue dimming
- LT30 – Low temperature
- 110V

EBDSPIR-HB | High Level Detectors



The EBDSPIR-HB series of PIR detectors are designed for high bay applications such as warehouses and factories.

- Ideal for high level/high bay applications
- Infrared programmable
- For mounting at heights up to 15m
- Surface mounting back boxes available

Dimensions (mm)

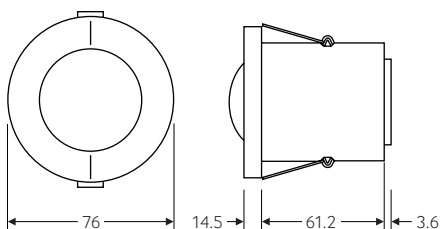

Detection pattern

high < sensitivity > low

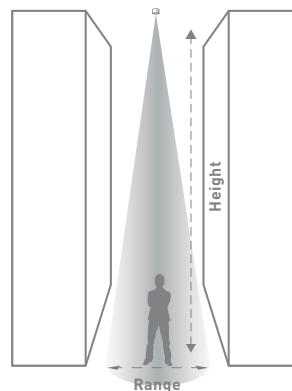

Height	Range
6m	2.0 x 2.0m
8m	2.7 x 2.7m
10m	3.4 x 3.4m
12m	4.0 x 4.0m
15m	5.1 x 5.1m

Available versions

- PRM – Switching
- DD – DALI/DSI dimming
- AD – Analogue dimming

EBDHS | High Level Detectors



The EBDHS PIR presence detector is developed for lighting control in areas with demanding spaces and increased mounting heights.

- Ground breaking detection range
- For mounting at heights up to 20m depending on operating parameters.
- Unique lens technology – high sensitivity
- Ideal for high level/high bay applications
- Supplied with adjustable masking shields to tailor detection zones

Detection pattern

high < sensitivity > low

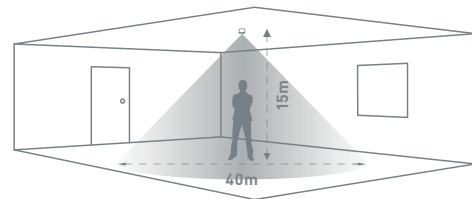

Dimensions (mm)

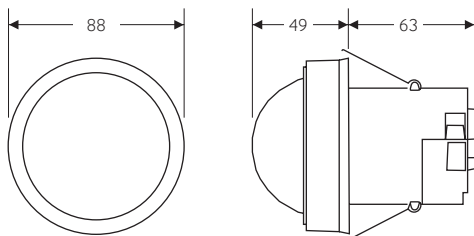

Available versions

- PRM – Switching
- DD – DALI/DSI dimming
- AD – Analogue dimming
- LV – Low voltage
- OC – Open collector
- LT30 – Low temperature

EBDHS-MB | High Level Detectors



The EBDHS-MB luminaire mount PIR presence detector provides exceptionally sensitive and long range detection. Ideal for high bay lighting control in areas with demanding spaces and increased mounting heights.

- Ground breaking detection range
- For mounting at heights up to 20m
- Ideal for high level/high bay applications
- Easy to retrofit to commercial luminaires and basic battens

Dimensions (mm)

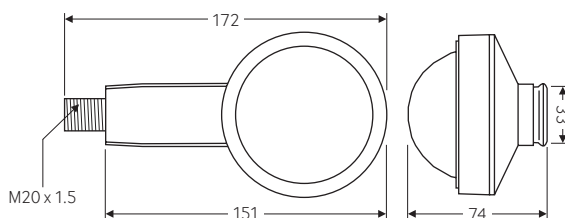

Detection pattern

high <sensitivity> low

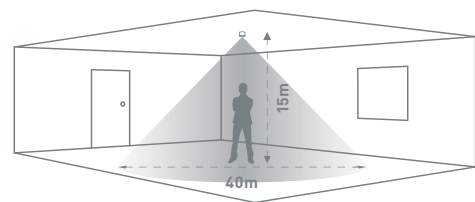

Available versions

- PRM – Switching
- DD – DALI/DSI dimming
- AD – Analogue dimming
- LT30 – Low temperature

MWS5 | Microwave Detectors

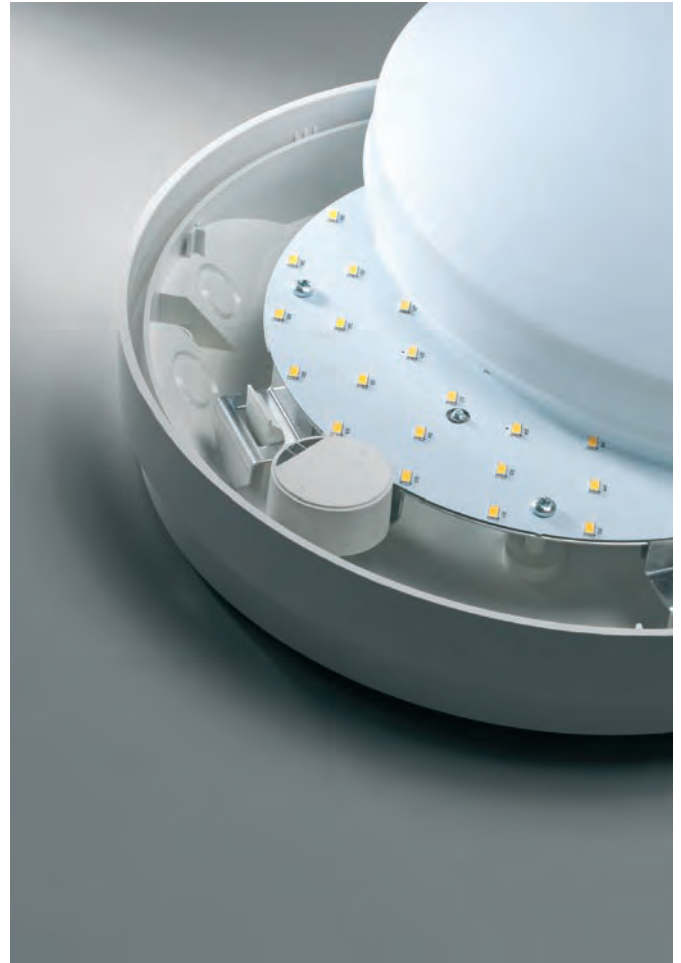

The MWS5 range of compact microwave detectors has been specifically designed to be mounted within a luminaire. They are sensitive to movement and are ideal for large spaces that have an awkward shape.

- Can be flush or surface mounted
- Remote power supply allows head to be fitted in confined spaces
- Suitable for wall or ceiling mounted luminaires
- A selection of fixing clips to allow the unit to be mounted in or to the side of a luminaire are available
- Please see page 16 for power supply options and information

Dimensions (mm)

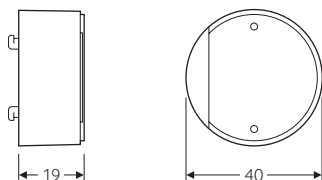

Detection pattern

high < sensitivity > low

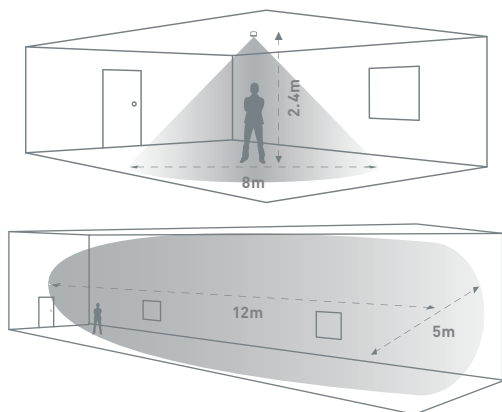

Available versions

- PRM – Switching
- DD – DALI/DSI dimming
- AD – Analogue dimming
- LV – Low voltage

MWSINT | Microwave Detectors

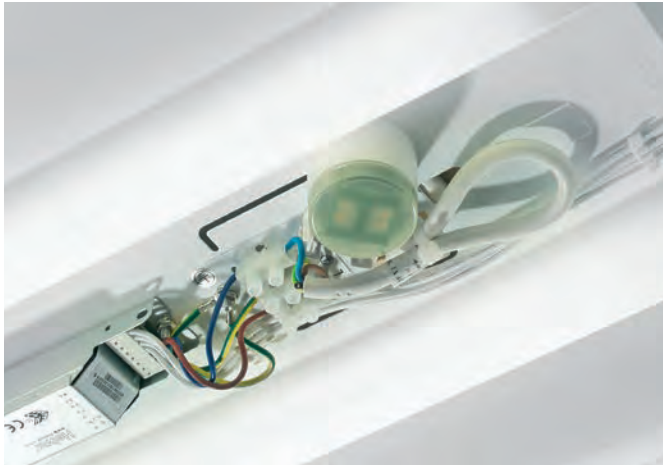

The MWSINT series of self-contained microwave presence detectors has been specifically designed to be mounted within a luminaire.

- Self-contained unit with integrated power supply
- Infrared programmable
- Can be mounted inside a luminaire
- Suitable for wall or ceiling mounted luminaires

Dimensions (mm)

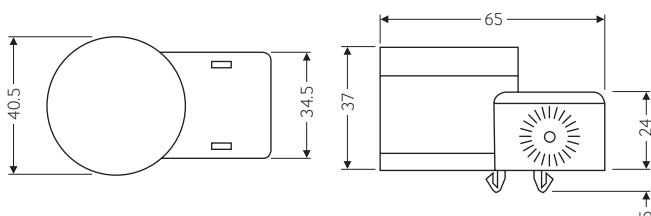

Detection pattern

high < sensitivity > low

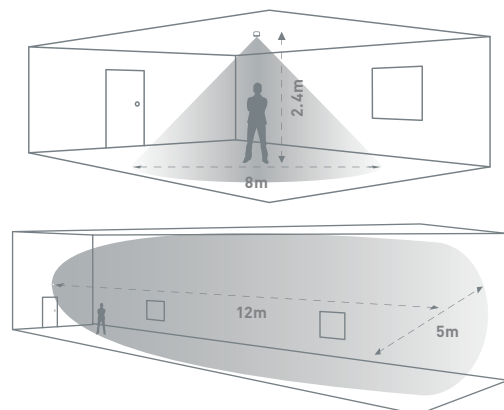

Available versions

- PRM – Switching
- DD – DALI/DSI dimming
- AD – Analogue dimming

Power Supply Units

The majority of our detectors are self-contained. For our compact and miniature detectors we have a choice of Power Supply Units (PSUs).

The standard PSU provides absence and presence detection. The Slimline PSU provides presence detection and is ultra compact, perfectly suited to be installed into T5 profile luminaires.



Slimline PSU



Standard PSU

Slimline PSU

- Provides power and connections for presence detection
- Uses a spring connection system for the terminals making it easy and quick to install
- 2 amp relay switching
- Up to 10 x (DSI/DALI) drivers/ballasts
- Up to 4 x (DSI/DALI) drivers/ballasts with relay version
- Up to 4 x (1–10V) drivers/ballasts with relay version

Standard PSU

- Provides power and connections for absence and presence detection
- Uses a spring connection system for the terminals making it easy and quick to install
- 6 amp relay switching
- Up to 20 x (DSI/DALI) drivers/ballasts
- Up to 10 x (DSI/DALI) drivers/ballasts with relay version
- Up to 10 x (1–10V) drivers/ballasts with relay version

Dimensions (mm)

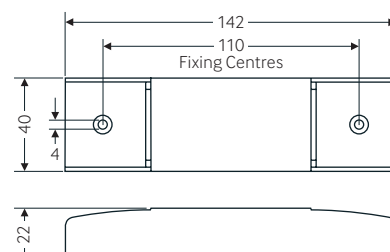
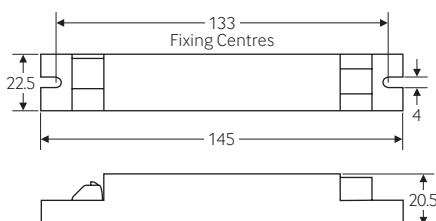

Infrared Handsets

Our range of infrared (IR) handsets have been designed to allow simple configuration, programming and maximum user convenience.

There's a handset to suit every user, whether it's the commissioning engineer configuring hundreds of detectors, a contractor setting up two or three, or a user who simply wishes to override a setting or switch between pre-programmed scenes.



UNLCDHS

UNLCDHS – Professional commissioning LCD programming handset

- The UNLCDHS is a compact infrared handset used for the operation, configuration and programming of CP products that have the ability to be programmed via IR. These include the PRM, DD, AD, Vitesse Plus, RAPID, D-Mate and An-10 ranges.
- IR range up to 20m



UHS5



UHS7

UHS5 – Commissioning handset

- The UHS5 is a compact infrared handset used for the basic programming of IR enabled CP products
- IR range up to 7m

UHS7 – User handset

- User handset for simple scene setting, on off, raise + lower
- IR range up to 7m



Low Temp Detectors

Following rigorous testing in climatic chambers and on-site, our Minus30 range of lighting controls is specifically designed for the cold storage and refrigeration sector, performing at aggressive -30° temperatures.



EBMPIR-MB-LT30



EBDSPIR-LT30



EBDHS-LT30



EBDHS-MB-LT30

KNX® Presence Detectors

CP Electronics brings its extensive functionality to KNX, the worldwide standard for unifying all communication between intelligent devices that light, heat and ventilate homes and buildings.

Key features:

- Presence detector, either PIR or microwave
- Absence detection
- Walk test LED
- Light level sensor
- Two ELV switch inputs
- Infrared remote control sensor to facilitate control of lighting
- User-configurable logic functions and timers

Configuration of devices on the KNX bus takes place via the standard ETS software application, allowing all aspects of the presence detector's behavior to be configured and controlled.



EBDSPIR-KNX



EBDHS-KNX



MWS3A-KNX



MWS6-KNX



DALI Accessories

CP Electronics have developed a range of DALI accessories for direct integration into third party DALI networks together with DALI broadcast offerings.

The range consists of PIR detectors suitable for mounting heights up to 20m. It also contains DALI addressers that connect to a DALI addressable network and provide a DALI or DSI broadcast output. Analogue 1-10v versions are also available.

A number of DALI power supplies are available together with a single channel broadcast scene plate offering four lighting level pre-sets/scenes.



EBDSPIR-DNET1



EBDHS-DNET1

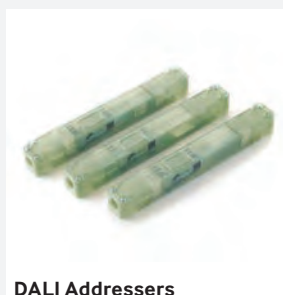

DALI Addressers

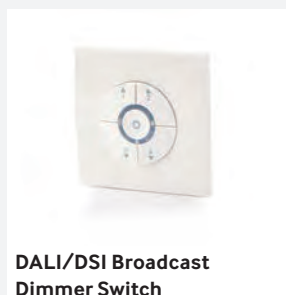

DALI/DSI Broadcast Dimmer Switch



Slimline PSU



DIN Rail PSU

Bespoke Products

CP Electronics can offer a number of bespoke products for direct integration into third party networks and control systems, typically providing extra low voltage or open collector outputs.

Other product developments also include specific detectors for direct connection such as Philips SR Xitanium drivers.

Open collector/low voltage heads

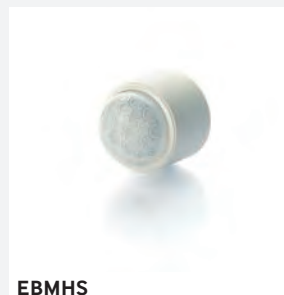

EBMHS

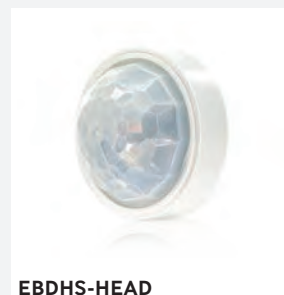

EBDHS-HEAD



EBMHS-IP

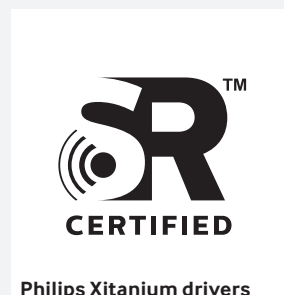

Philips Xitanium drivers



Wireless Lighting Control

An-10 wireless technology allows you to install a fully featured lighting control system easily and with minimal disruption.

An-10 has been specifically created to allow you to embrace the advantages of wireless technology, while at the same time offering all of the features and functionality demanded by modern day lighting control systems.

Selected An-10 wireless components

Please request a brochure or see our website for the complete An-10 range.



High level detector



Compact PIR detector



Driver/ballast controllers



Adjustable microwave presence detector

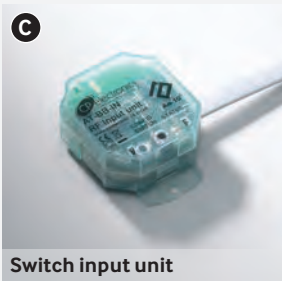

Switch input unit



Scene plate



High level detector



Wireless adapter

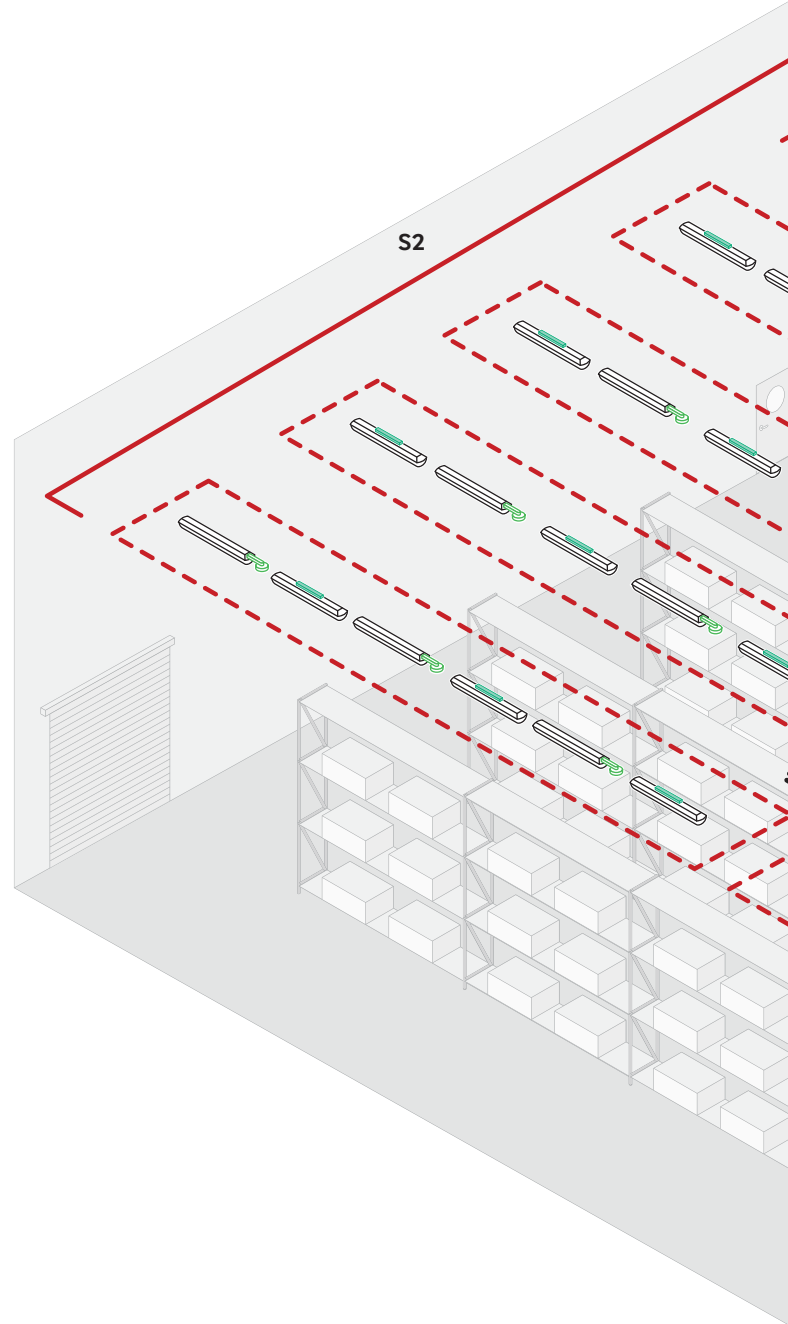

An-10 warehouse application

In this warehouse layout, triggering a detector in any aisle, shown by the red dotted lines, sends an RF signal to all associated devices, both presence detectors and luminaire driver/ballast controllers, within the aisle illuminating the work area.





Movement in any of these racking aisles is used to keep the main central aisle illuminated allowing passage of people and vehicles into adjacent areas.

The wireless switch inputs are utilised to manually turn on the S1 & S2 areas to a pre-determined light level for maintenance and stock taking purposes.

Daylight linking in rows available.



Key

-  Groups
-  Group held on by aisles
-  S1 - Switch RH aisles
-  S2 - Switch LH aisles



Room Control System

Economical scene setting and energy control

D-Mate® provides a cost effective scene setting system with all the benefits of energy saving control. It is fully modular and integrates perfectly with CP Electronics presence detectors and other switching devices such as scene plates – all designed by CP.

Users also benefit from intuitive infrared control handsets which strengthens the overall value offering of D-Mate.

D-Mate system components

A



Switch input unit

B

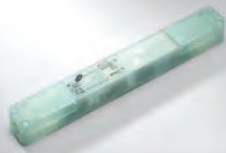

Slimline PSU

C



Scene plate

D



Compact PIR detector

E



Addressers

F



Handset

Ideal for a wide variety of applications

D-Mate® is suitable for a wide range of application including office spaces, hotel rooms and control rooms. Ideal for retrofit solutions where lighting control and scene setting needs to be introduced.

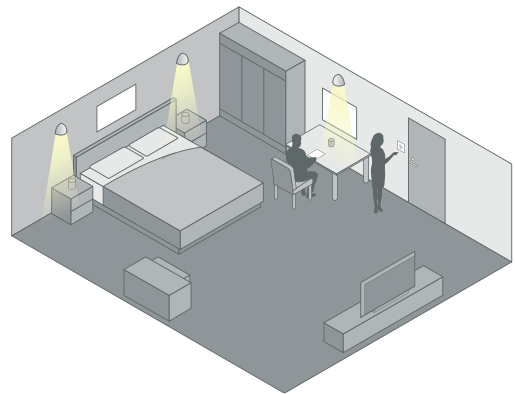

Hotel Rooms

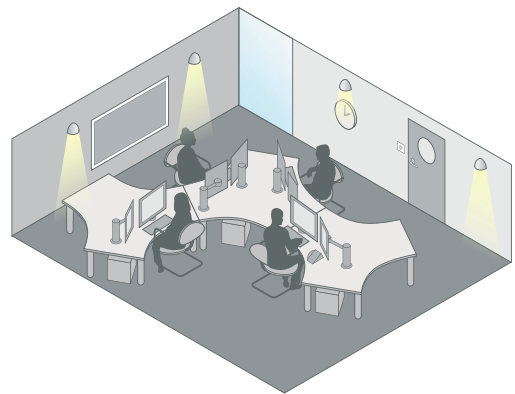

Control Rooms

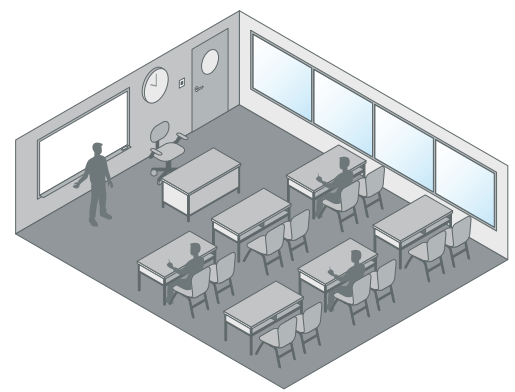

Classrooms

D-Mate meeting room application

When entering the meeting room, the lighting switches on automatically. The background light level required can be selected by recalling one of the fully programmable scenes via the scene plate located at the entrance door. Additional control can be achieved by utilising addressers and switch inputs. Addressers allow the lighting to be further broken down into a greater number of control groups, switches used in conjunction with addressers, that can provide manual control over these groups such as that shown for override of the presentation screen.

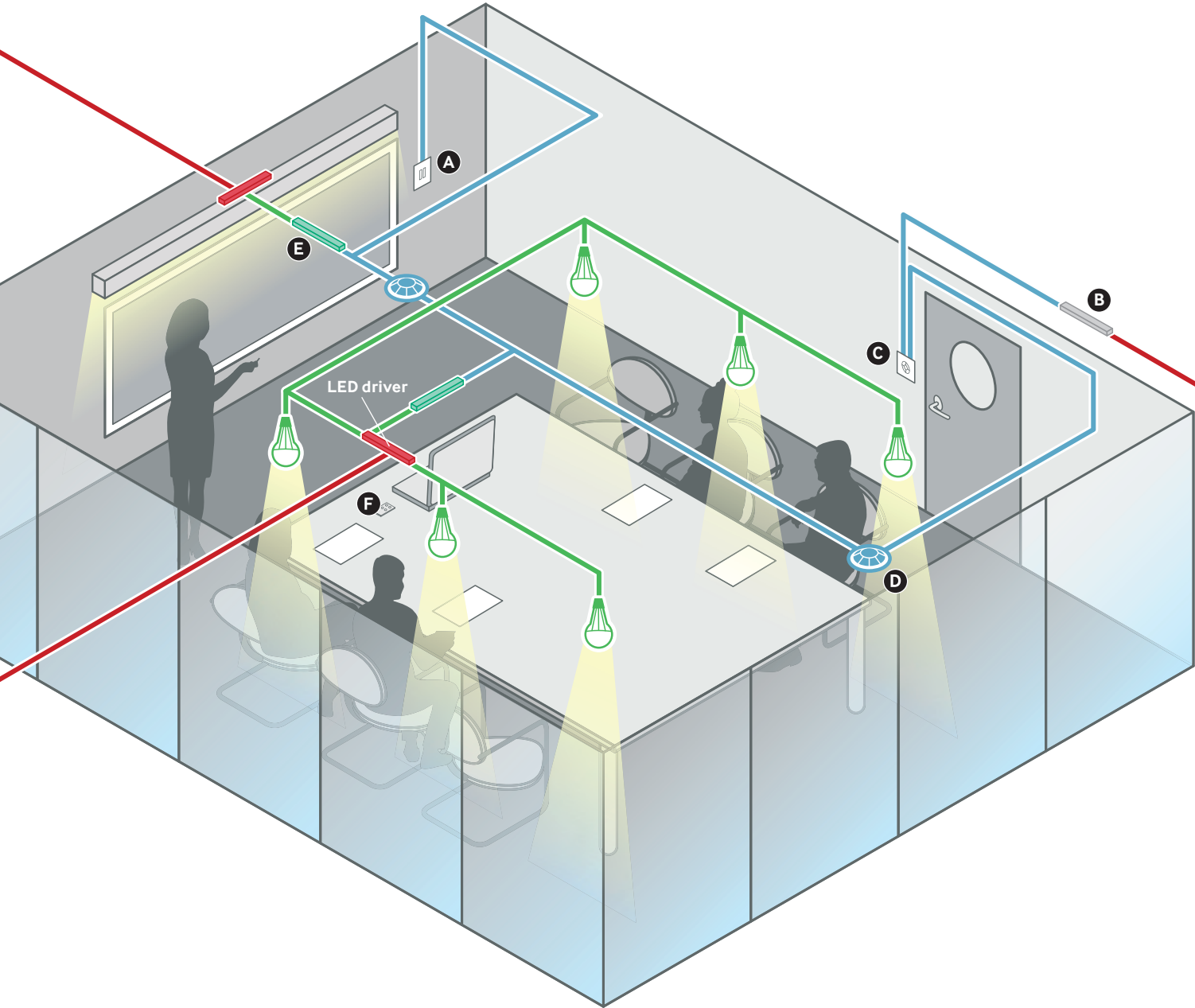

Key

- 240v
- D-Mate Bus
- DALI Control



CP Electronics Ltd.
Brent Crescent
London
NW10 7XR
United Kingdom

t. +44 (0)333 900 0671

f. +44 (0)333 900 0674

oem@cpelectronics.co.uk

connect with us    

Visit www.cpelectronics.co.uk/oem for product information,
or www.cpelectronicscorporate.com for company information.